

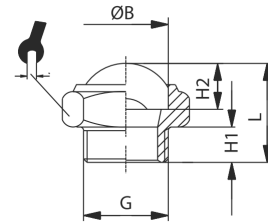

## Schalldämpfer flach Edelstahl silencer plain stainless steel



<b>Betriebstemperatur</b>	-20°C bis +70°C	<b>operating temperature</b>	-20°C up to +70°C
<b>Betriebsdruck</b>	max. 12bar	<b>operating pressure</b>	max. 12bar
<b>Werkstoff</b>	Sinterbronze (36µm) Messing (Ms58) Edelstahl (AISI 304)	<b>material</b>	sintered bronze (36µm) brass (Ms58) stainless steel (AISI 304)
<b>Medium</b>	Druckluft	<b>medium</b>	compressed air

G	ØB [mm]	H <sub>1</sub> [mm]	L [mm]	H <sub>2</sub> [mm]	
G1/8	11,0	6,0	16,0	4,0	13,0
G1/4	14,0	8,0	19,0	4,0	16,0
G3/8	17,0	9,0	21,0	4,0	19,0
G1/2	22,0	10,0	23,0	4,0	24,0
G3/4	28,0	10,0	27,0	4,0	30,0
G1	34,0	15,0	29,0	4,0	36,0
M5	6,5	3,5	8,0	3,0	8,0

**weitere Optionen und Zubehör auf Anfrage**  
more options and accessories on request