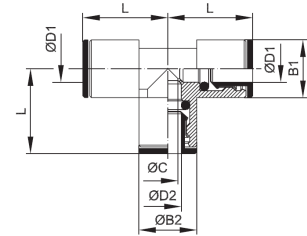
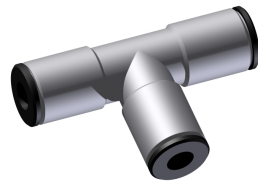

T-Verbinder
T-connector

| | | | |
|---------------------------|--|------------------------------|--|
| Betriebstemperatur | -20°C bis +70°C | operating temperature | -20°C up to +70°C |
| Betriebsdruck | max. 16bar | operating pressure | max. 16bar |
| Werkstoff | Gehäuse Messing (Ms58) vernickelt Dichtung aus NBR silikonfrei Spannzange aus Edelstahl 1.4404 Druckring aus Kunststoff schwarz | material | body brass (Ms58) nickel-plated silicon-free NBR seals stainless steel clamp 1.4404 black plastic thrust ring |

| ØD1 [mm] | ØD2 | ØB1 [mm] | ØB2 [mm] | ØC [mm] | L [mm] |
|----------------------------|------|-------------|-------------|------------|-----------|
| 3,0 | 3,0 | 7,0 | 7,0 | - | 13,0 |
| 4,0 | 4,0 | 9,0 | 9,0 | 3,0 | 17,0 |
| 5,0 | 5,0 | 9,5 | 9,5 | 4,0 | 19,0 |
| 6,0 | 6,0 | 11,0 | 11,0 | 5,0 | 19,5 |
| 8,0 | 8,0 | 13,0 | 13,0 | 7,0 | 23,0 |
| 10,0 | 10,0 | 15,0 | 15,0 | 8,0 | 25,0 |
| 12,0 | 12,0 | 17,0 | 17,0 | 10,0 | 27,0 |
| 14,0 | 14,0 | 20,0 | 20,0 | 12,0 | 31,0 |
| Reduziert / reduced | | | | | |
| 6,0 | 4,0 | 11,0 | 9,0 | 3,0 | 19,5 |
| 8,0 | 6,0 | 13,0 | 11,0 | 5,0 | 23,0 |
| 10,0 | 8,0 | 15,0 | 13,0 | 7,0 | 25,0 |

weitere Optionen und Zubehör auf Anfrage
more options and accessories on request