

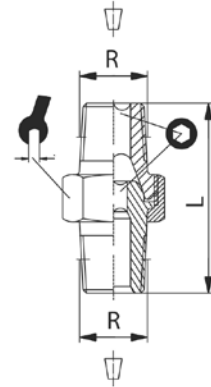

**Doppelnippel lösbar – blank, kon.**  
*double nipple con. detachable*

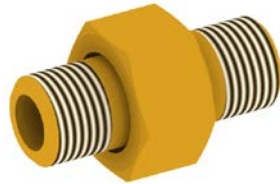

<b>Betriebstemperatur</b>	max. +150°C	<b>operating temperature</b>	max. +150°C
<b>Betriebsdruck</b>	max. 6obar	<b>operating pressure</b>	max. 6obar
<b>Werkstoff</b>	Messing (Ms58) vernickelt und blank	<b>material</b>	brass (Ms58) nickel-plated and polished

A [mm]	B [mm]	Ø [mm]	 [mm]	 [mm]
R1/8	27,0	5,3	15,0	5,0
R1/4	34,0	6,3	19,0	6,0
R3/8	36,0	8,5	22,0	8,0
R1/2	40,0	13,0	27,0	12,0
R3/4	52,0	15,0	36,0	14,0
R1	65,0	20,0	46,0	19,0
R1/8-R1/4	30,0	5,3	15,0	5,0
R1/4-R3/8	35,0	6,3	19,0	6,0

**weitere Optionen und Zubehör auf Anfrage**  
*more options and accessories on request*